

Addendum – Sliding Door Operators

This addendum is to be used in conjunction with the Installation & Instruction Manual.

Commercial & Industrial Heavy Duty Sliding Door Operator (For single and bi-parting sliding doors)

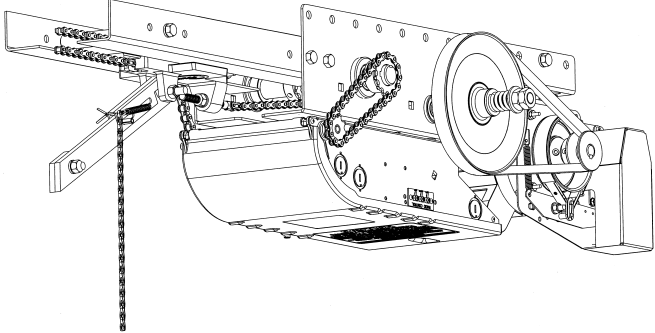

OSL

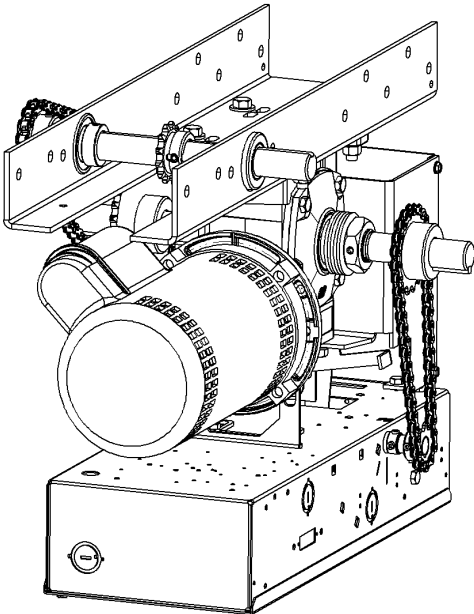

MGSL

<p>READ AND FOLLOW ALL INSTRUCTIONS. SAVE THESE INSTRUCTIONS. GIVE TO END-USER.</p>
Serial # _____
Model # _____
Wiring Diagram # _____
Project #/Name _____
Door #/Name _____



Installation Instructions

IMPORTANT INSTALLATION INSTRUCTIONS

WARNING

TO REDUCE THE RISK OF SEVERE INJURY OR DEATH TO PERSONS:

1. READ AND FOLLOW ALL INSTALLATION INSTRUCTIONS.
2. Install only on a properly operating door. A door that is operating improperly could cause severe injury. Have qualified service personnel make repairs to cables, spring assemblies and other hardware before installing the operator.
3. Remove all pull ropes and remove, or make inoperative, all locks (unless mechanically and/or electrically interlocked to the power unit) connected to the door before installing the operator.
4. Installation of this door operator must be done by a qualified installer.
5. Verify that the operator is correct for type, size of door and frequency of use per the operator specifications.
6. Install the door operator at least 8 feet (2,44 m) or more above the floor. If the operator must be installed less than 8 feet (2,44 m) above the floor, then exposed moving parts must be protected by covers or guarding, provided by the operator manufacturer.
7. Do not connect the door operator to the source of power until instructed to do so.
8. Locate the control station: (a) within sight of the door, and (b) at a minimum height of 5 feet (1,5 m) above floors, landings, steps or any other adjacent walking surface and (c) away from all moving parts of the door.
9. Install the Entrapment Warning Placard next to the control station in a prominent location.
10. For products having a manual release, instruct the end user on the operation of the manual release.
11. If you have any questions about the safety of the door operating system, do not install the operator, contact Manaras-Opera at 1-800-361-2260.

1 Operator Installation

1.1 Quick View - Sliding Door Operator Typical Installation

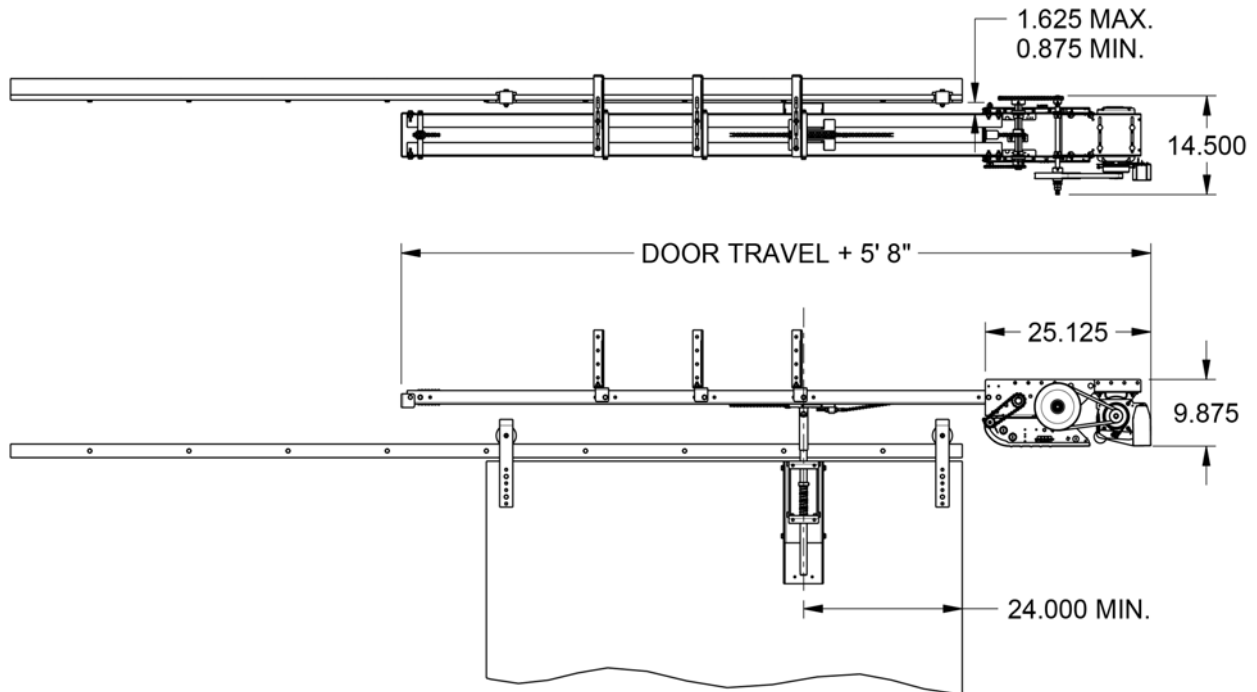

Figure 1 - Sliding Single Door Operator Typical Installation
(Operator Installed on the Right Shown)

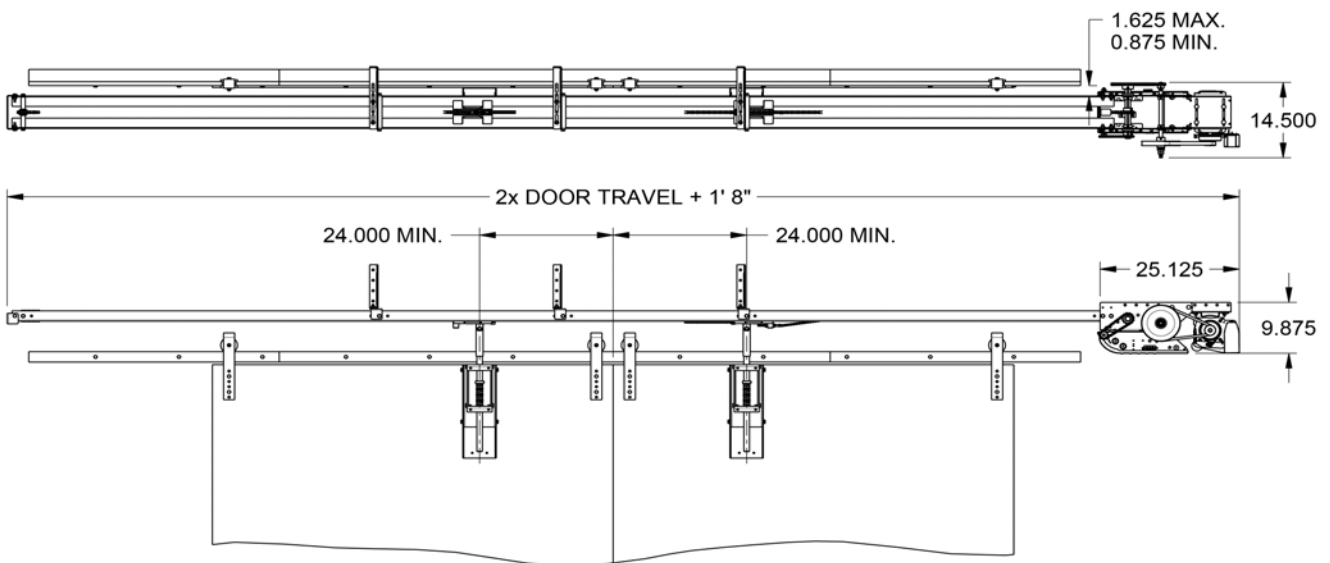

Figure 2 - Sliding Bi-Parting Door Operator Typical Installation

1.2 Assembly Instructions



CAUTION

The operator has exposed moving parts and to prevent access to the pinch points, this operator must be installed at least 8 feet (2,44 m) or more above the floor. Alternatively, covers or guarding, provided by the manufacturer, must be installed when the operator is mounted less than 8 feet (2,44 m) above the floor.

NOTICE

- Install the operator only when all openings of a horizontal slide door are guarded or screened from bottom of the door to a minimum of 4 ft (1,22 m) above the ground to prevent a 2-¼ in (57,2 mm) diameter sphere from passing through the openings anywhere in the door.

- 1** Attach the tracks to the operator.

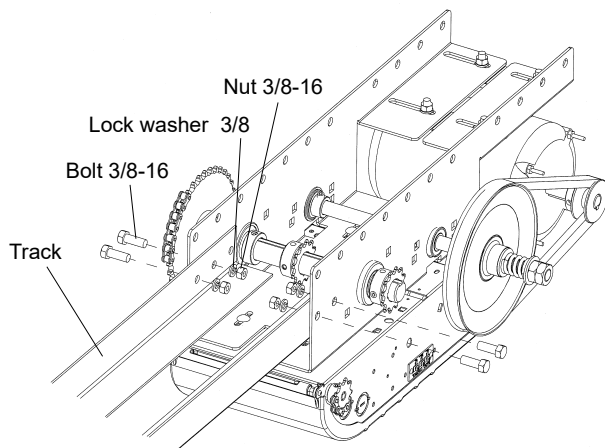

- 2** Assemble the carriage.

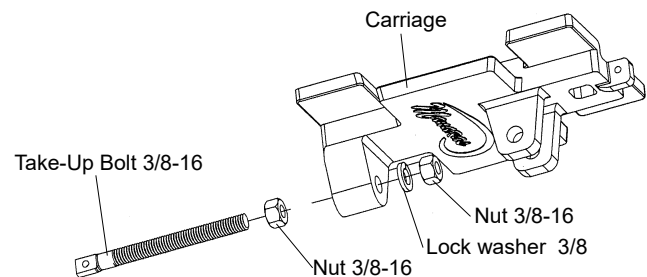

- 3** Slide the carriage on the track towards the operator.

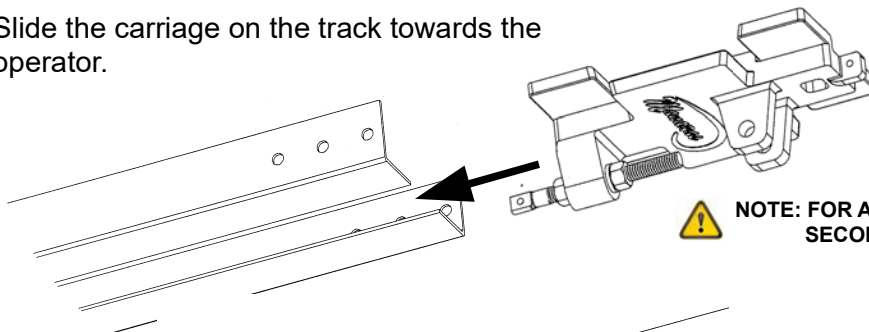

NOTE: FOR A BI-PARTING DOOR, SLIDE THE SECOND CARRIAGE AS WELL.

Operator Side

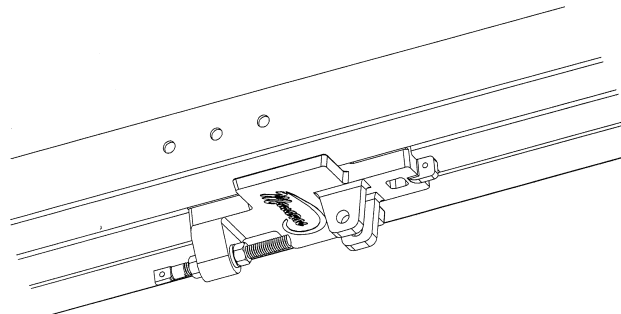

4 Install spacers and front idler.

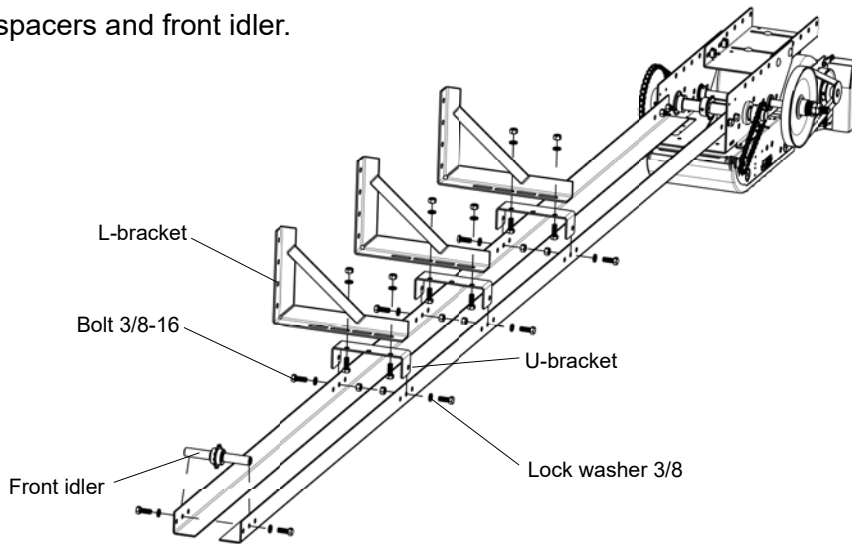

5 Install the chain.

A) Attach the chain to the front end of the carriage.

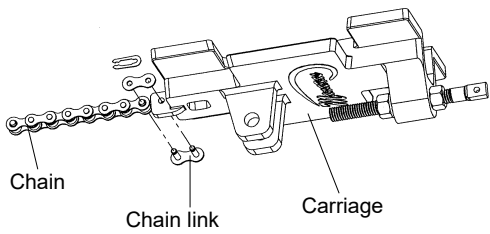

B) Wrap the chain around the front idler.

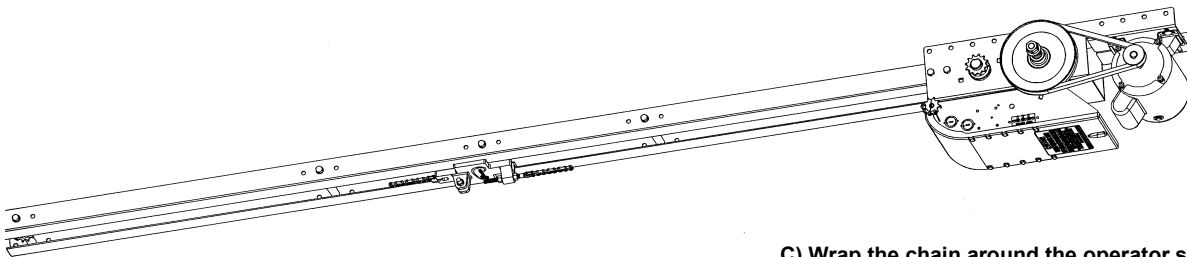
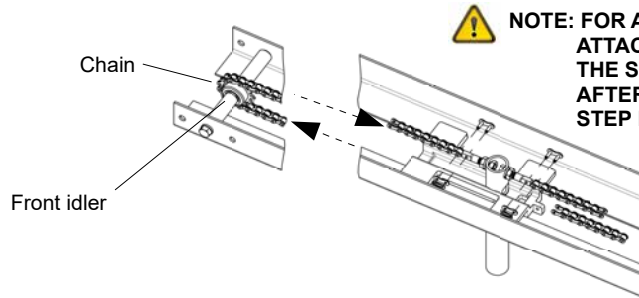

C) Wrap the chain around the operator sprocket.

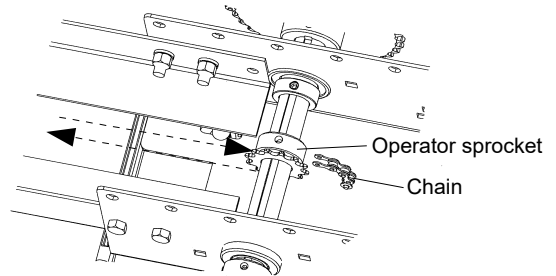

D) Attach the chain to the back of the carriage.

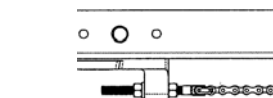
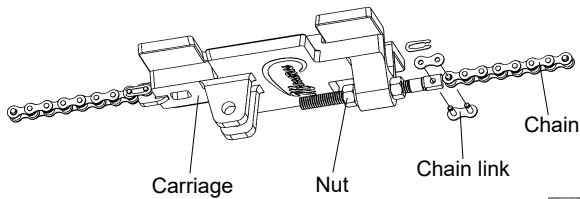

E) Adjust the tension on the chain.

1.3 Installation

- 1 Determine the clearance required for the door to operate freely.

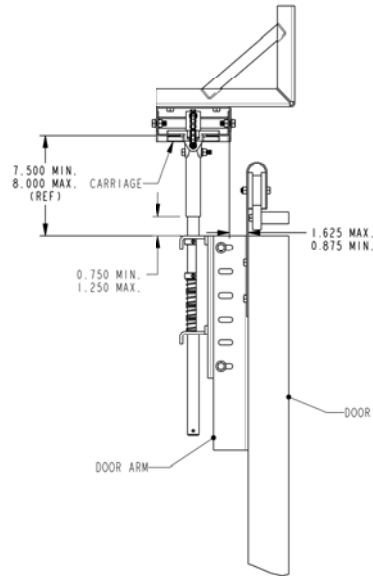

- 2 Measure the clearance required.

A) For a Single-Door:

Draw a line 24" from the door's edge towards the center to mark the center of the door arm.

Begin on the right edge of the door if the operator is installed on the right side of the door or begin on the left edge of the door if the operator is installed on the left side of the door.

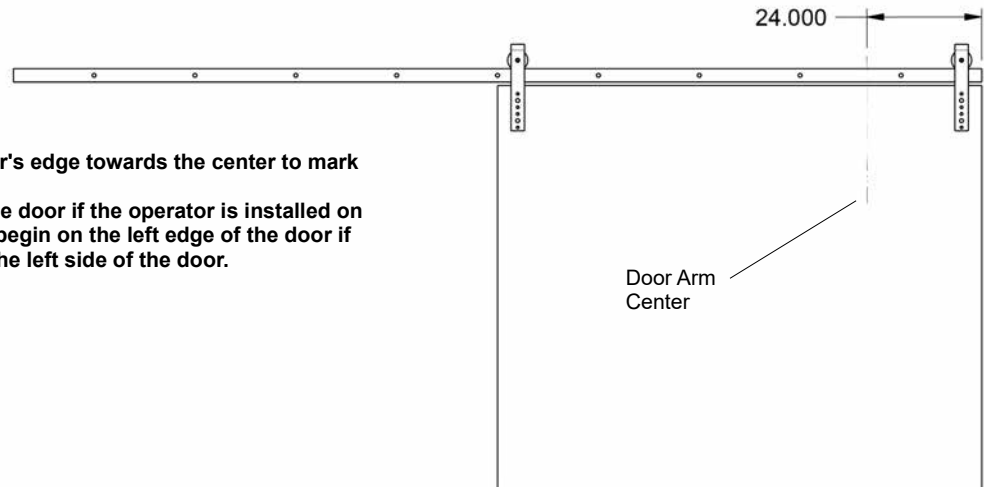

Figure 3 - Single Door – Operator Installed on the Right Shown

B) For a Bi-Parting Door:

Draw a line 24" from the door's inner edge to the mark the center of the door arm. Repeat in the other direction for the second door arm.

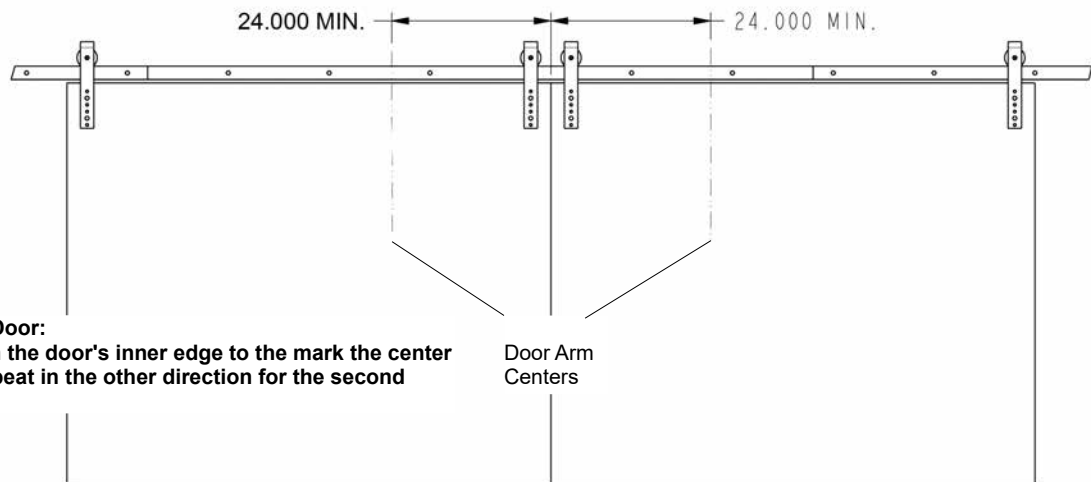
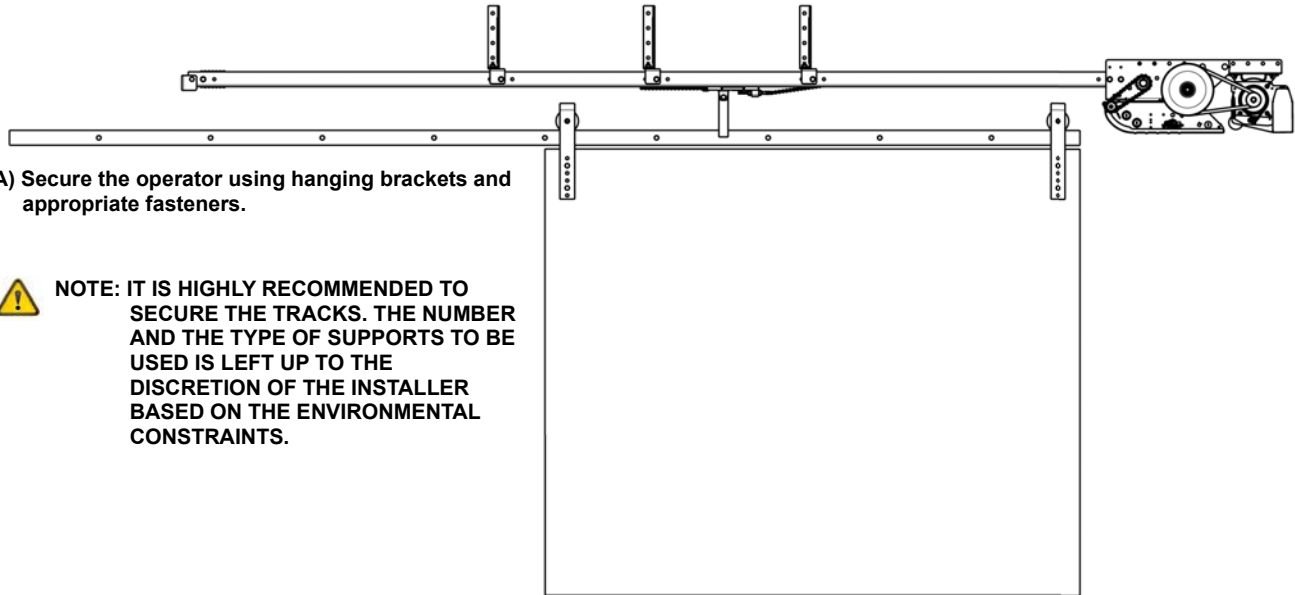

Figure 4 - Bi-Parting Door

3 Position and hang the operator and track assembly.



NOTE: ENSURE THAT THE OPERATOR, THE TRACKS AND THE DOORS ARE PARALLEL.



A) Secure the operator using hanging brackets and appropriate fasteners.



NOTE: IT IS HIGHLY RECOMMENDED TO SECURE THE TRACKS. THE NUMBER AND THE TYPE OF SUPPORTS TO BE USED IS LEFT UP TO THE DISCRETION OF THE INSTALLER BASED ON THE ENVIRONMENTAL CONSTRAINTS.

4 Mount the door arm to the door and to the carriage.

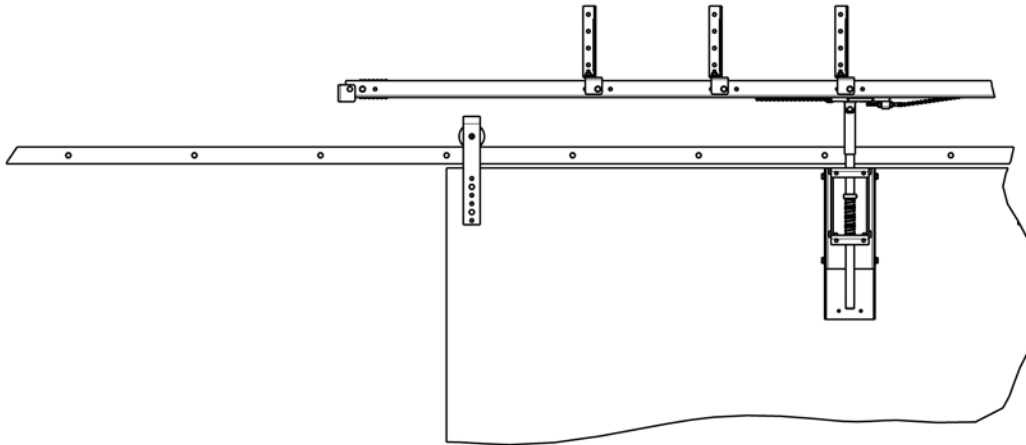

5 Disconnect (Optional).

Install the disconnect lever on the door and pass the cable from the door arm shaft to the disconnect lever.

2X FASTER*



RAPIDO™ TWICE AS FAST

OPEN AND CLOSE YOUR DOOR TWICE AS FAST WITH A RAPIDO OPERATOR FROM MANARAS-OPERA.

The RAPIDO™ features a door speed up to 2 times faster than standard models available to the commercial and industrial door market.

The RAPIDO™ increases the longevity of the complete door system, designed to speed-up industrial standard lift sectional doors while smoothly managing soft-starts and soft-stops.

CHOOSING THE RAPIDO™ IS SIMPLE WHEN TIME AND ENERGY SAVINGS IS A MUST.

On-board control and monitoring of external entrapment protection devices, provide speed managing features and enhanced performance and reliability.

*The RAPIDO™ operator is up to 2X the speed of a standard jackshaft operator.

CALL US FOR MORE INFORMATION: 1-800-361-2260

www.manaras.com



- MEMBER OF THE CANIMEX GROUP -